



## **LOKI**

**Bendable for mounting  
on flat or curved surfaces**

# **USER GUIDE**

# 1.Product Description

LOKI silicone bendable LED light has effective resistance to impact and corrosion . It can bend backward up to 30° . Better anti-yellowing and antioxidantlens design than traditional ones. 3M VHB tape mounting and screw mounting.

## 2.Technical Specifications

Product Name	LOKI
Max Power	10W
Voltage	DC 10-33V
Flash Pattern	Single 19/ Dual 12
IP Rating	IP67+IP69K
Operating Temperature	-30°C to +70°C
Dimensions	100*23*10mm(Bezel-Free)
Certifications	ECE R65 Class 1, ECE R10, SAE J845, T13

## 3.Product Introduction

### 3.1. Dimensions

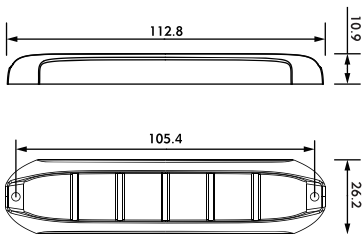

## 3.2. Wirings

### A. Function Wiring

#### Single Color

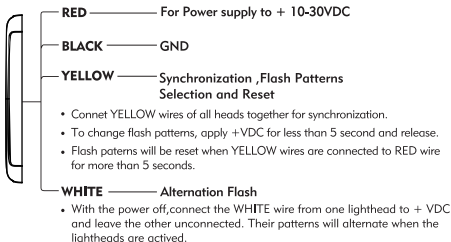

#### Dual Color

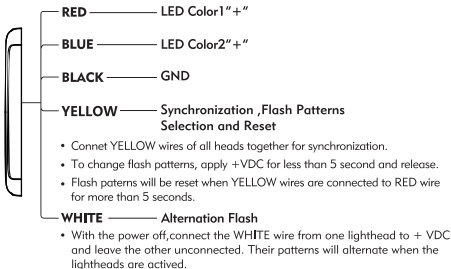

## B. Products Wiring

### Pattern Synchronization

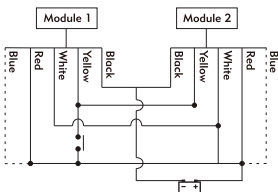

### Pattern Alternation

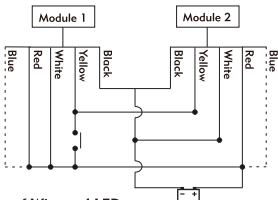

## C. Color Sheet of Wire and LED

### Dual Color

LED Combinations \ WIRE	RED	BLUE
024118TAW	W	A
024118TBW	W	B
024118TRW	W	R
024118TAR	A	R
024118TAB	A	B
024118TBR	R	B

## 4. Mounting

### A. Screw Mounting With Included Bezel

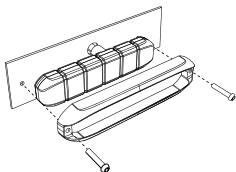

### B. 3M VHB Tape Mounting

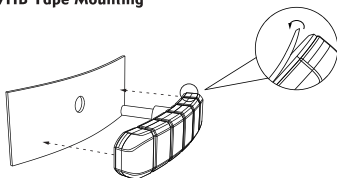

### Warning

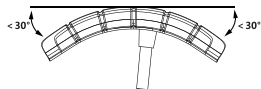

Max 30° angle from center



No Twisting



No Pulling

## SINGLE & SPLIT FLASH PATTERNS

1	Random (Default)	11	Single (All)
2	Single (Split)	12	Double (All)
3	Double (Split)	13	Quad (All)
4	Quad (Split)	14	Quint (All)
5	Quint (Split)	15	Ultra (All)
6	Ultra (Split)	16	Single-Quad (All)
7	Single-Quad (Split)	17	Single-H/L (All)
8	Single-H/L (Split)	18	Steady 2 (California)
9	ECE R65 Single (All)	19	Steady 4 (All)
10	ECE R65 Double (All)		

## DUAL FLASH PATTERNS

1	Steady 2 (Default)	7	Double (All)
2	Steady 4 (All)	8	Quad (All)
3	Random (All)	9	Quint (All)
4	ECE R65 Single (All)	10	Ultra (All)
5	ECE R65 Double (All)	11	Single-Quad (All)
6	Single (All)	12	Single-H/L (All)