

TECHNICAL DATA SHEET

Ref. 500023

UNIPOLAR BATTERY

MASTER SWITCH

24VDC / 100A



GENERAL CHARACTERISTICS

Protection degree: IP63
Ambient temperature: -40°C to +85°C
Weight: 0.222 Kg approx.
Contacts: Copper
Connections: not polarized

FIELDS OF APPLICATION

Handling vehicles, industrial vehicles,
agriculture machinery, industry...

POWER CIRCUIT

Connection: M10 terminals
Tightening torque: 1.5 +/- 0.1 daN·m
Type: D1 normally open
Nominal current: 100 A
Nominal voltage: 24 VDC
Max. capacity: 500 A during 5 seconds

PARTICULAR CHARACTERISTICS:

Security key control

SPARE PARTS

Key 520000

Size diagrams

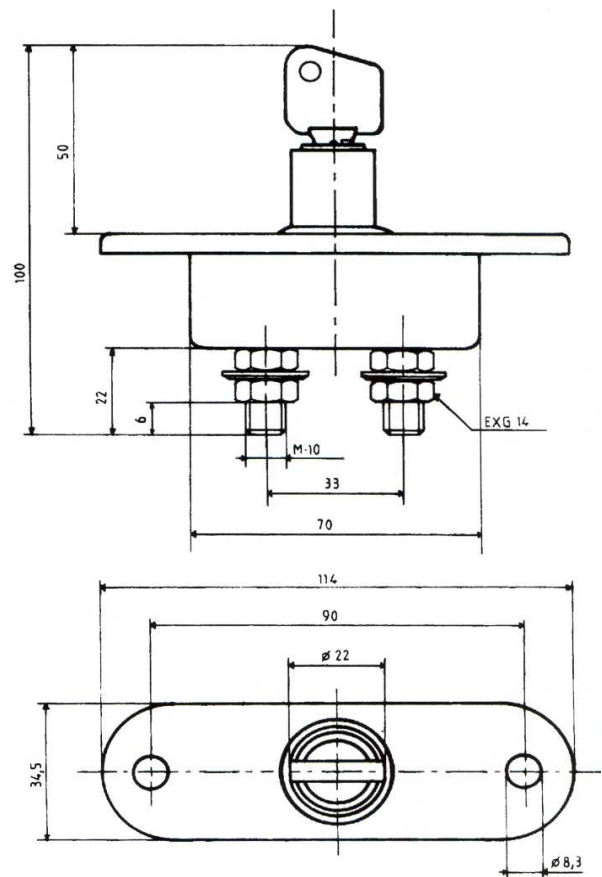

Connection diagram

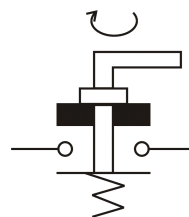

Fixing diagram

