

NOTE: Recommended for low voltage <32VDC (automotive) applications.  
Also suited for use in 125-250VAC applications, restrictions may apply (see below).

Rating [ mA ]	Ud (Voltage drop) [ mV ]	iMaXX Reference
100	2500	F4100
200	1700	F4200
250	1400	F4250
300	1300	F4300
400	1200	F4400
500	1000	F4500
800	250	F4800

Rating [ A ]	Ud (Voltage drop) [ mV ]	iMaXX Reference
1	200	F4001
1.25	200	F4001.25
1.6	190	F4001.6
2	170	F4002
2.5	170	F4002.5
3.15	150	F4003
4	130	F4004
5	130	F4005
6.3	130	F4006
8	ns *	F4008
10	ns *	F4010
12	ns *	F4012
15	ns *	F4015
16	ns *	F4016
20	ns *	F4020

\*) ns means not in standard, not specified

Fusing time, ratings 32 - 100mA		
Load [%]	Minimum	Maximum
210 %	-	1,800 s
275 %	10 ms	500 ms
400 %	3 ms	100 ms
1000 %	-	20 ms

Fusing time, ratings 125mA - 6.3A		
Load [%]	Minimum	Maximum
210 %	-	1,800 s
275 %	50 ms	2,000 ms
400 %	10 ms	300 ms
1000 %	-	20 ms

Fusing time, ratings 8A - 10A		
Load [%]	Minimum	Maximum
210 %	-	1,800 s
275 %	50 ms	2,000 ms
400 %	10 ms	400 ms
1000 %	-	40 ms

Fusing time, ratings > 10A		
Load [%]	Minimum	Maximum
210 %	-	1,800 s
275 %	100 ms	6,000 ms
400 %	20 ms	600 ms
1000 %	-	60 ms

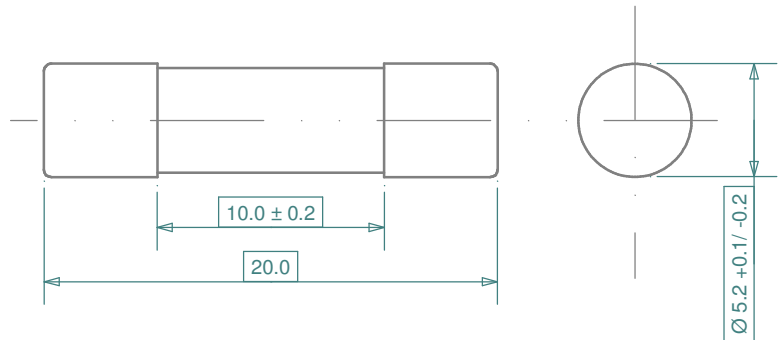

NOTES
Glass tube with nickel plated caps
IEC 127, BS4265 and CEE4 standard sheet II
Marked with voltage and current rating
Range from 100mA up to 6.3A per standards
Ratings not in IEC/BS standards, from 8 - 20A also available
Breaking capacity: min. 35A or 10 x rated current (In), (125mA - 10A)
Breaking capacity: 100A @ 250VAC (12A - 15A)
Operating ambient temperature from 15°C to 35°C per standards
Cycling test as per IEC 127 and BS4265

Revisions			Date	Appr.	
	Date	Type	Drawn	09/01	GRH
a	07/07	re-drawn	Checked	06/13	BE
b	12/09	extended specification details	Standards		
c	06/13	added note on voltage rating	Approved	06/13	AdH



		Scale 3 : 1		Title	F4000 series, glassOTO 5x20mm fuse
		Projection	Tolerance ± 0.5 mm unless otherwise noted	Drawing type	schematic
				Drawing number	F4000 drawing 1
				Sheet	1 of 1
				Layers	0 1 2 6 8 9