

REV.	REVISION HISTORY	NAME	DATE
0	FIRST ISSUE	M.LAGUARDIA	10.12.2015
1	SCREW (+) MODIFIED WAS L=15.5 BECAME L=19	M.LAGUARDIA	19.04.2016
2	OPERATING FEATURE UPDATED	M.CORBANI	02.11.2016
3	MODIFIED BODY WITH CHAMFER AND UPDATED INDEX TO 0301045/1x	G.CASULA	27.05.2019

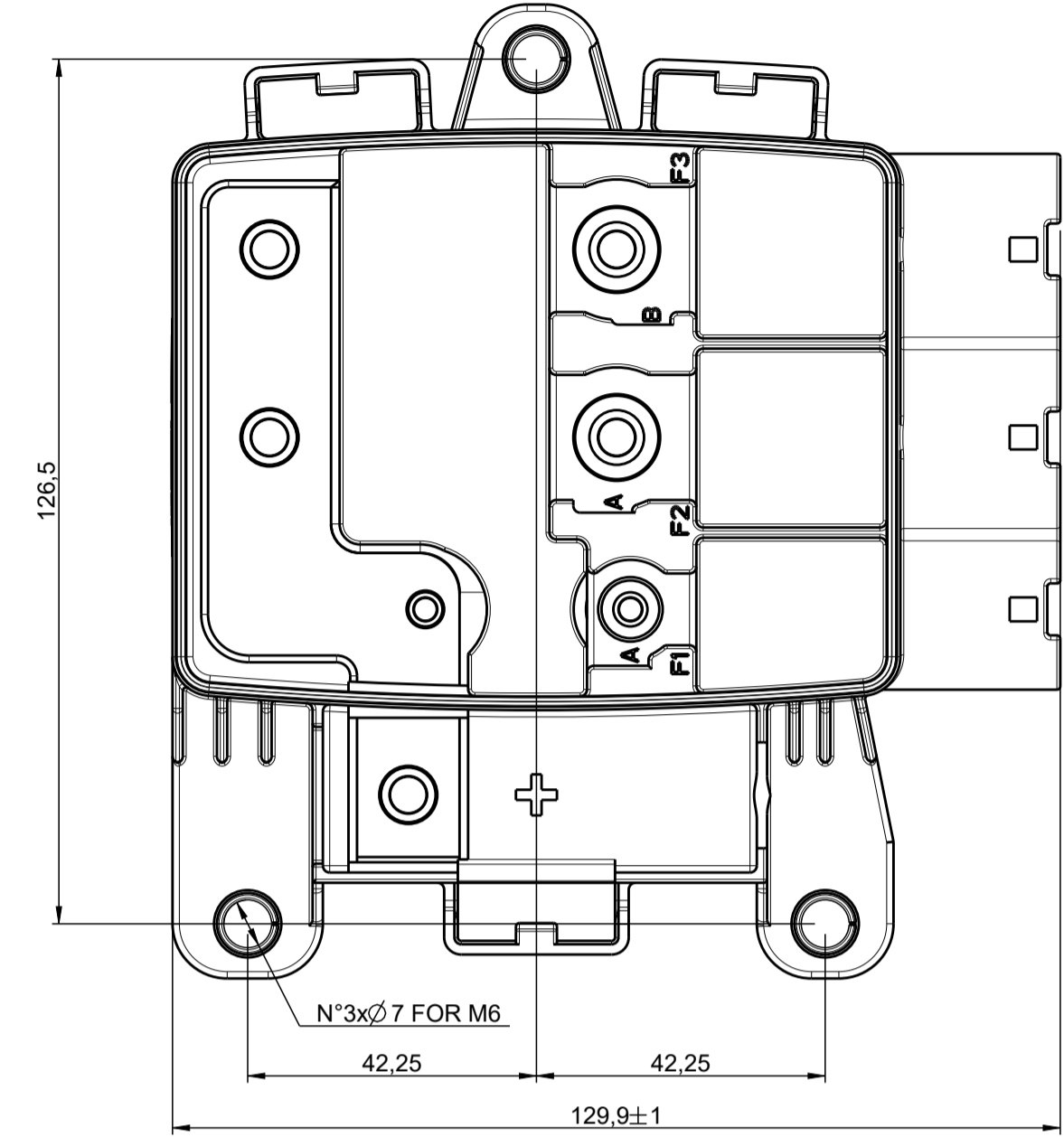

EVENTUAL PLASTIC BURR IS ALLOWED IN THIS SIDE. A PLASTIC BURR IS DUE TO THE INSERTION PROCESS OF COMPRESSION LIMITER

TRACEABILITY LABEL POSITION: ALLOWED ROTATION OF 180°

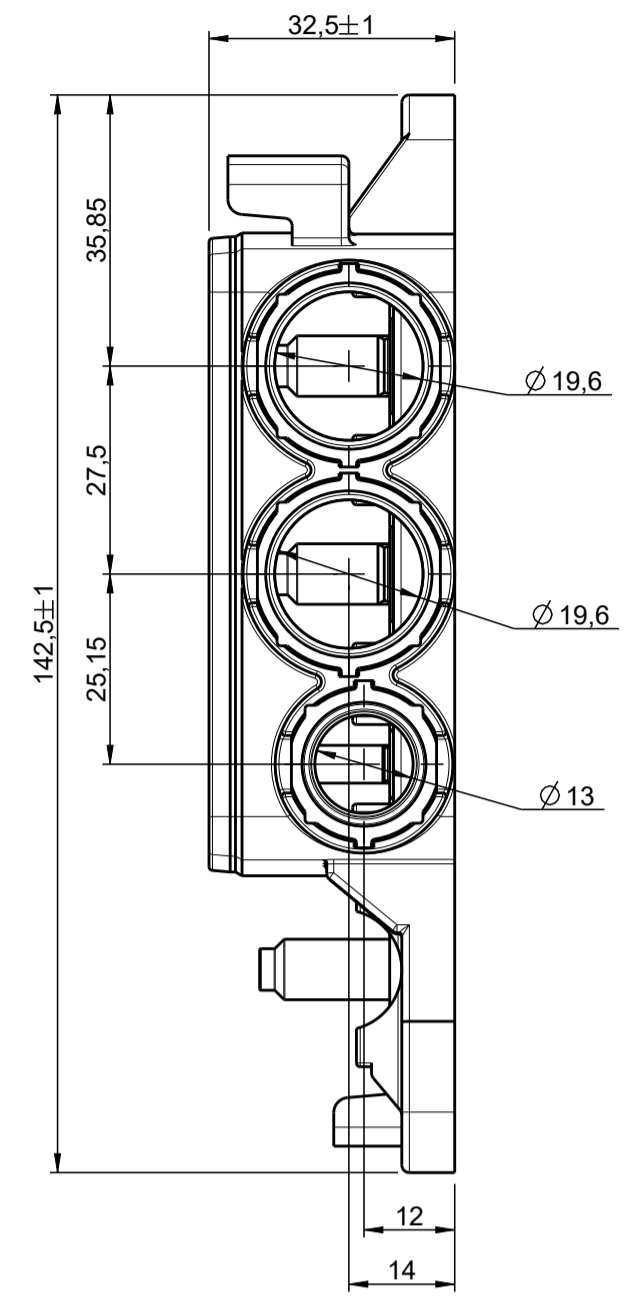
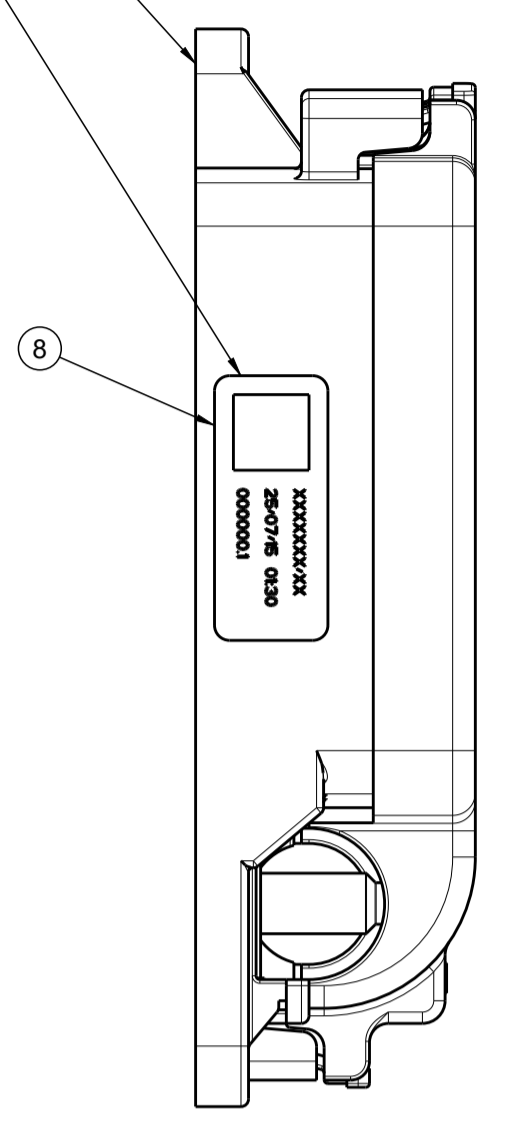

VIEW WITH COVER

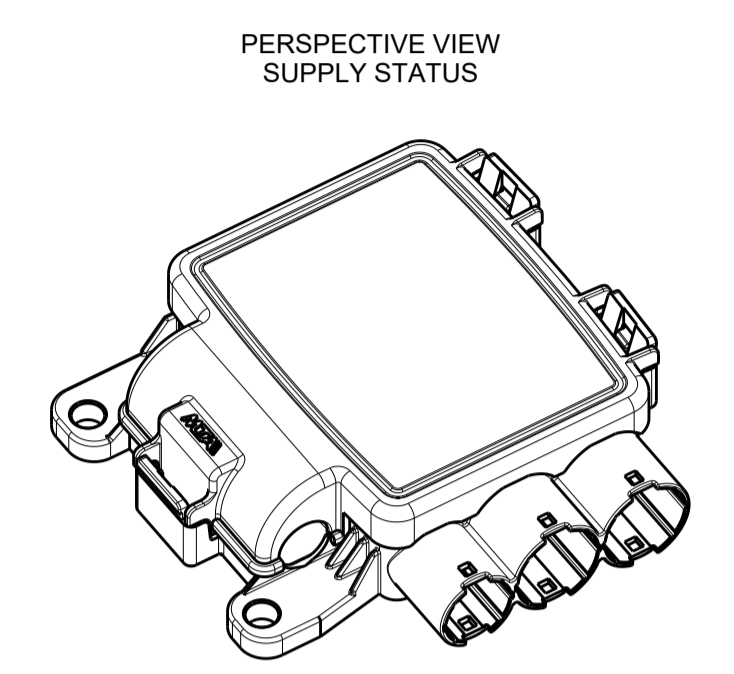

PERSPECTIVE VIEW SUPPLY STATUS

SCALE 1:2

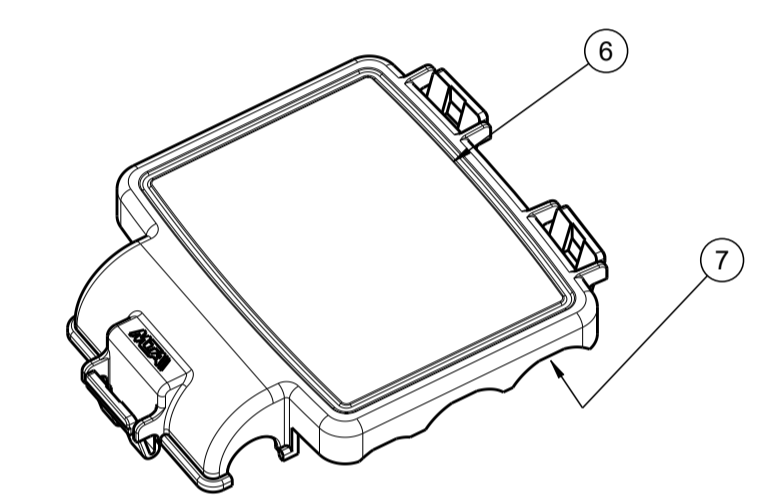

SCALE 1:2

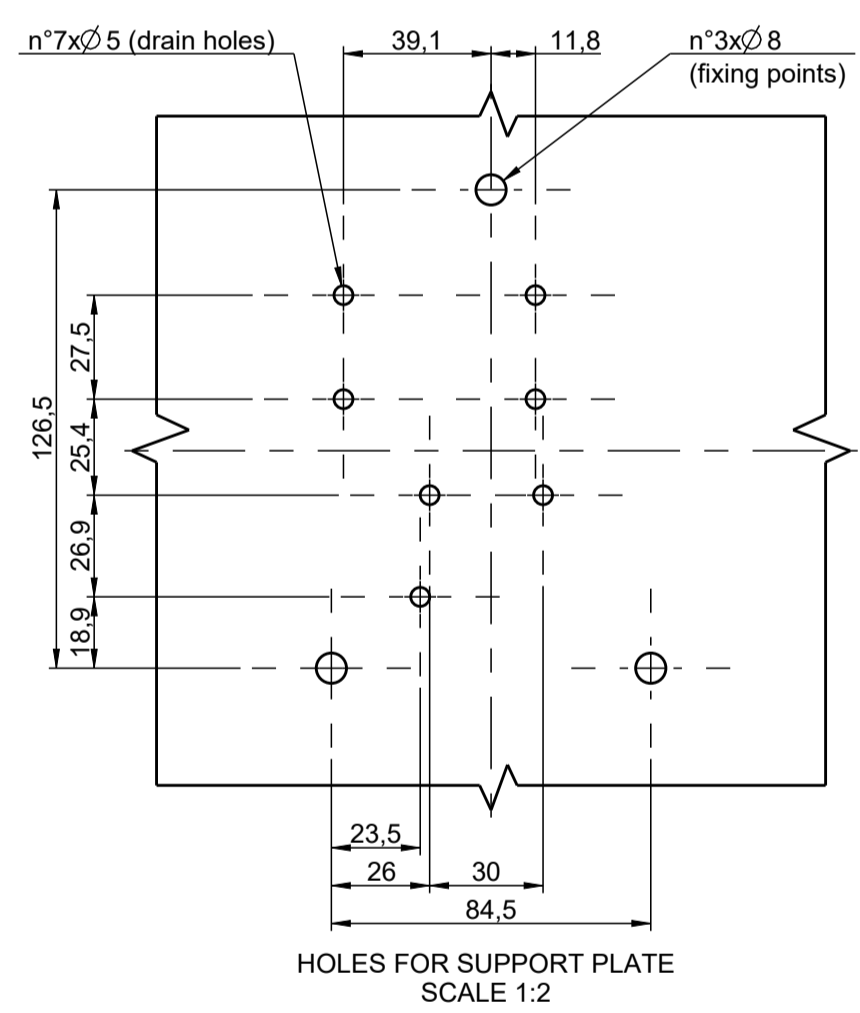

HOLES FOR SUPPORT PLATE SCALE 1:2

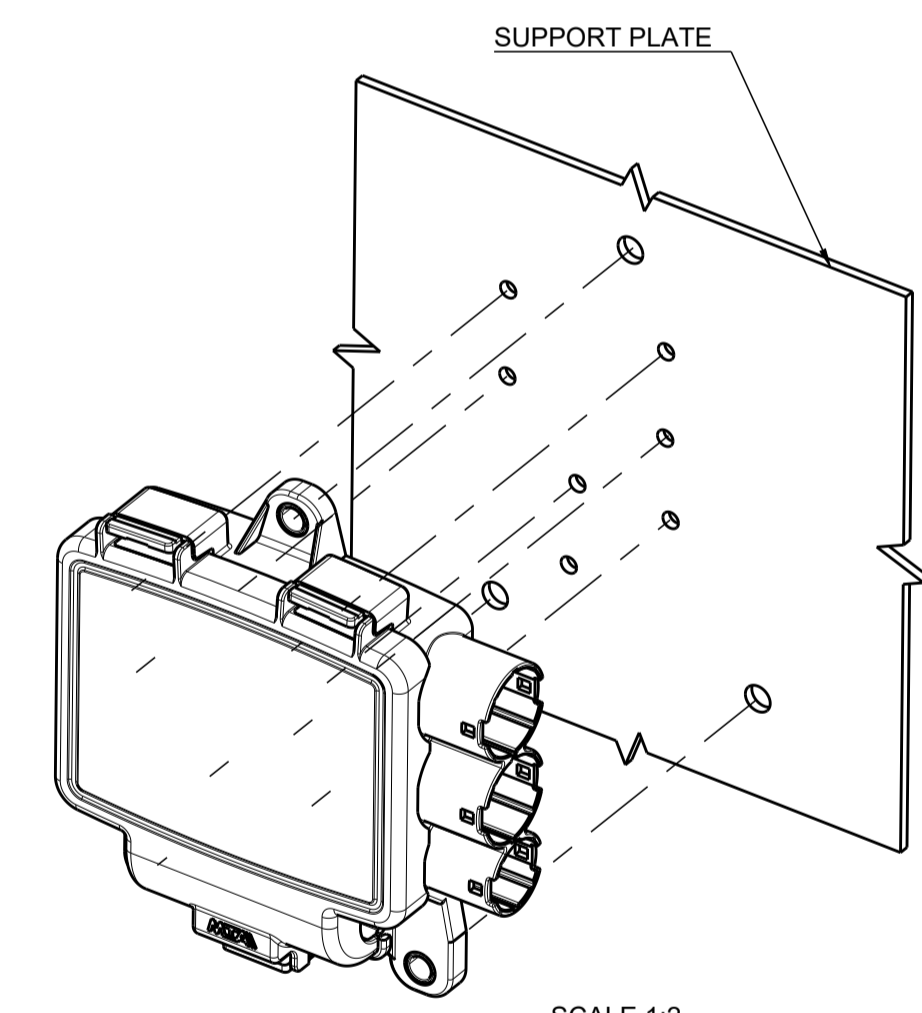

SCALE 1:2

TO AVOID RESISTANCE INSULATION PROBLEMS, IT'S RECOMMENDED TO HAVE CLEARANCE ON THE METAL BRACKET AS SHOWN HERE

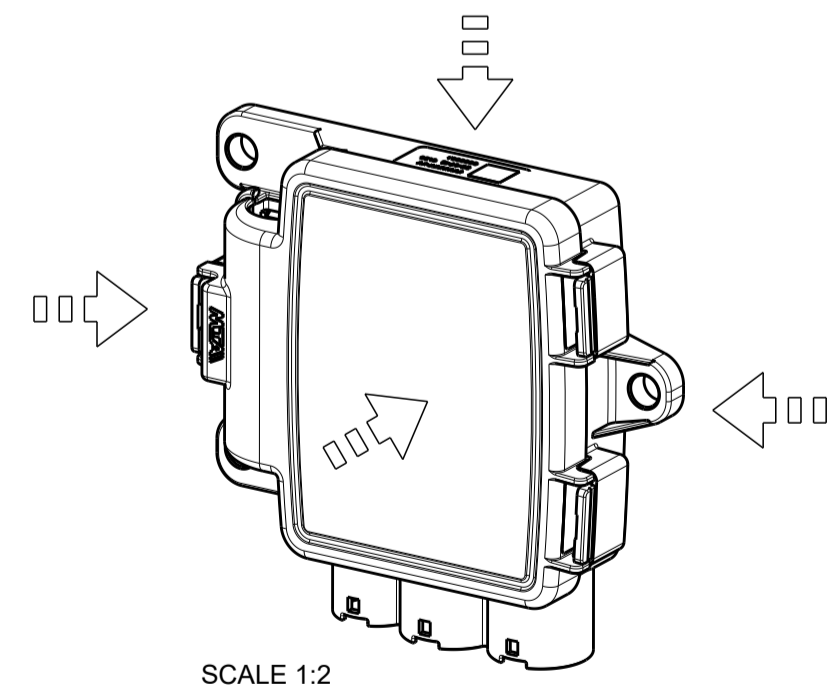

SCALE 1:2

(*) MTA GUARANTEE IP 6K9K IN ALL DIRECTIONS SHOWN BY THE ARROWS. AVOID USING HIGH-PRESSURE WATER IN THE LOWER PARTS OF THE FUSEBOX, CABLES ENTRY SIDE

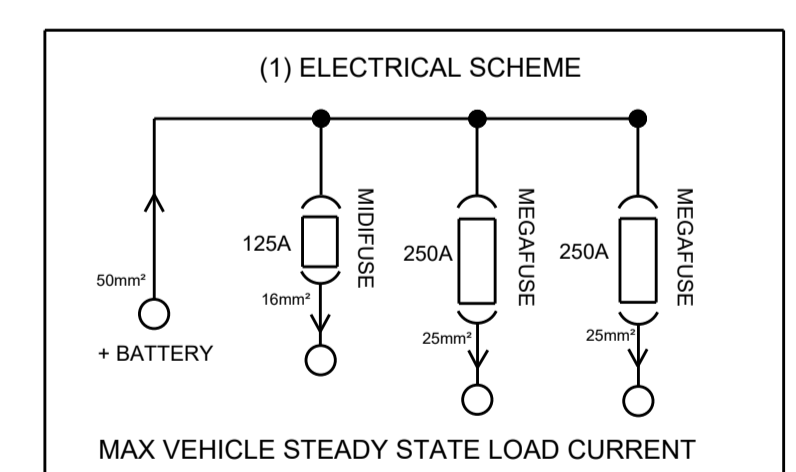
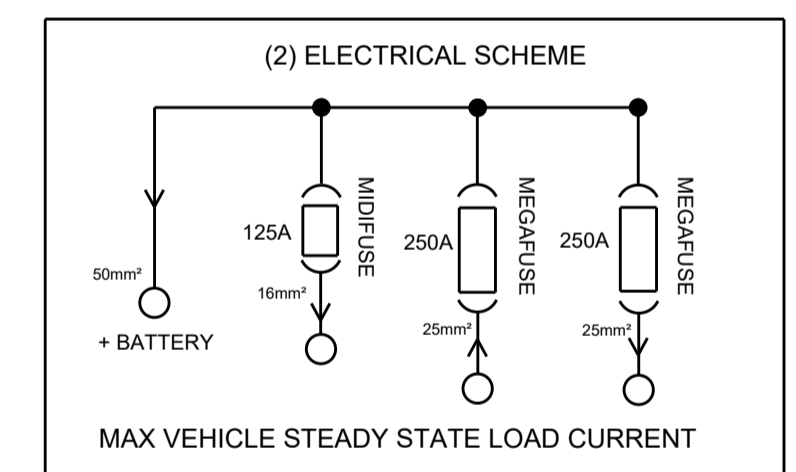

ASSEMBLY HANDBOOK REF. 9951441

OPERATING FEATURES		
FEATURES	UNIT	VALUE
V MAX	V	32
I MAX	A	165A@85°C (1) 105A@85°C (2)
OPERATIONAL TEMPERATURE RANGE	°C	-40 / +100
IP	-	6K9K (*)
FLAMMABILITY	UL 94	HB
	FMVSS 302	<= 100 mm/min
TIGHTENING TORQUE M5	Nm	4.5± 1
TIGHTENING TORQUE M8	Nm	11± 20%
TIGHTENING TORQUE M6	Nm	5.4± 0.9

ADDITIONAL NOTE:
I MAX: VALUES OBTAINED USING ZINC FUSES
APPLICATION OF FUSES WITH DIFFERENT CONFORMATION THAN THE INDICATED ONE HAVE TO BE VERIFIED AND AUDITED ONE BE ONE.

POS.	Q.TY	DENOMINATION	MATERIAL
8	1	TRACEABILITY LABEL	PET
7	1	GASKET	SI 30 Shore YELLOW
6	1	COVER	PP GF30 (HB) BLACK
5	1	BUSBAR	Cu ETP - Sn
4	2	SCREW M5	STEEL Cl. 8.8 - ZnNi
3	5	SCREW M8	STEEL Cl. 8.8 - ZnNi
2	3	COMPRESSION LIMITER	Fe P01 - ZnNi
1	1	BODY	PBT GF20 (HB) BLACK

ASSOCIATED TABLE REFERENCE		MTA P/N		Denom.	
POS.	TERMINAL (MTA P/N)	WIRE SECTION (sqmm)	SEAL (MTA P/N)	SEAL/TUBE FIXING (MTA P/N)	
+	1607510/xx	50+70	-	-	
F1	1705715/xx	6+8	see drawing 0300457/xx	see drawing 0300452/xx	
	1705855/xx	10+20			
F2	1609330/xx	25+40	see drawing 0300460/xx	see drawing 0300455/xx	
F3	1609340/xx	25+40			

UNCONTROLLED COPY
in case of drawing updating/revision
NO AUTOMATIC
resubmission will follow

REV 3 All proprietary rights reserved by MTA S.p.A. - This drawing shall not be reproduced, or in any way utilized, for the manufacture of the component or unit herein illustrated and must not be released to other parties, without written consent. Any infringement will be legally pursued.